



## DAYSTAR REVERSE ACTING ELECTRONIC PHOTOCONTROL

The Daystar Sensor System enhanced electronic photocontrol provides consistent, reliable, repeatable switching. The DayStar has the same proven operating performance as the Nightstar only with the load energized in the daytime position.

### FEATURES & BENEFITS

- Full ANSI C136.10 Compliance
- Silicon Light Sensing Providing Consistent, Repeatable Operation
- D.C. Positively Switched Relay Exceeds ANSI Load Life Requirements
- High Temperature Rated
- Fastest Delivery Time in the Industry
- Custom Stocking Programs Available

### MECHANICAL DATA

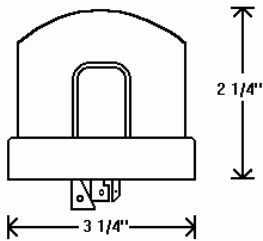

<b>Housing:</b>	UV stabilized impact resistant polypropylene.
<b>Base:</b>	High temperature ABS.
<b>Contact Blades:</b>	Solid brass, three prong, locking type.
<b>Gasket:</b>	Cross linked polyethylene
<b>Packaging:</b>	Individual units are sealed in water resistant plastic.
<b>Weight:</b>	3.0 oz. each, 20 lbs. per 100 unit carton.
<b>Size:</b>	16" x 16" x 12" per 100 unit carton.

### SPECIFICATIONS

<b>Input Voltage Options:</b> 105-130Vac, 50/60 Hz, 185-305Vac, 50-60 Hz, 105-305Vac, 50/60 Hz	<b>Operational Delay:</b> Instant On, 2-5 Seconds Off
<b>Load Switching Capability:</b> 5,000 operations at ANSI specified load test levels	<b>Operating Temperature:</b> -40°C to +70°C <b>Humidity:</b> 99% RH at 50°C
<b>Rated Load:</b> 1,000W/1,800VA	<b>Turn On to Turn Off Ratio:</b> 1:1.5 Standard
<b>Sensor Type:</b> Filtered Silicon Available	<b>Surge Protection:</b> 190J Standard, 380J Option

### ORDERING INFORMATION

- FP-RA-7673B Consult Factory